



The specialist for fastening technology

OUR   
**COMPETENCES**

**EUROTEC AS  
MANUFACTURER**

---

**EUROTEC PRODUCTS**











---

**EUROTEC AS A  
TRADER AND SUPPLIER**





# INDEX

	OUR COMPETENCES AS A MANUFACTURER	6 – 15
	OUR PRODUCTS	16 – 31
	DECK CONSTRUCTION AND LANDSCAPING	18 – 19
	TIMBER ENGINEERING	20 – 22
	WOOD CONSTRUCTION SCREWS	24 – 25
	ROOF AND FACADE	26 – 27
	CONCRETE AND MASONRY ANCHORS	28
	WOOD CONNECTORS	29
	SAFE & WORK	30
	TOOLWORKS	31
	EUROTEC AS A STRONG PARTNER	32 – 35

# OUR TECHNOLOGY AND ENGINEERING DEPARTMENT

Many of the processes and operations that other companies outsource to service providers are carried out in-house. By doing so, we ensure that you receive everything from a single source and that you have direct contacts within our company for your projects.

Originating from diverse areas of construction, our specialists produce designs in 2D or 3D, order and inspect initial samples, submit applications for certifications, make patent applications, issue approvals, monitor batch production, and much more.

**All items in the core product range are certified by an European Technical Approval** and test reports that are vital for the construction sector, reflecting our high quality standards. In addition to this, we also offer a broad portfolio of services. These vary from **free calculations for your construction projects** to a wide range of sales aids such as sets of sample shelves and sample decking, as well as various application videos. We even offer training for your staff.

With our products, we either respond to the general requirements of the market or work with customers to develop solutions for specific areas.

OUR CUSTOMERS RECEIVE A COMPLETE PACKAGE WITH AN EMPHASIS ON PRODUCT QUALITY.

TECHNICAL ADVICE IS AVAILABLE UNDER **+49 2331 62 45-444 OR [TECHNIK@EUROTEC.TEAM](mailto:TECHNIK@EUROTEC.TEAM)**

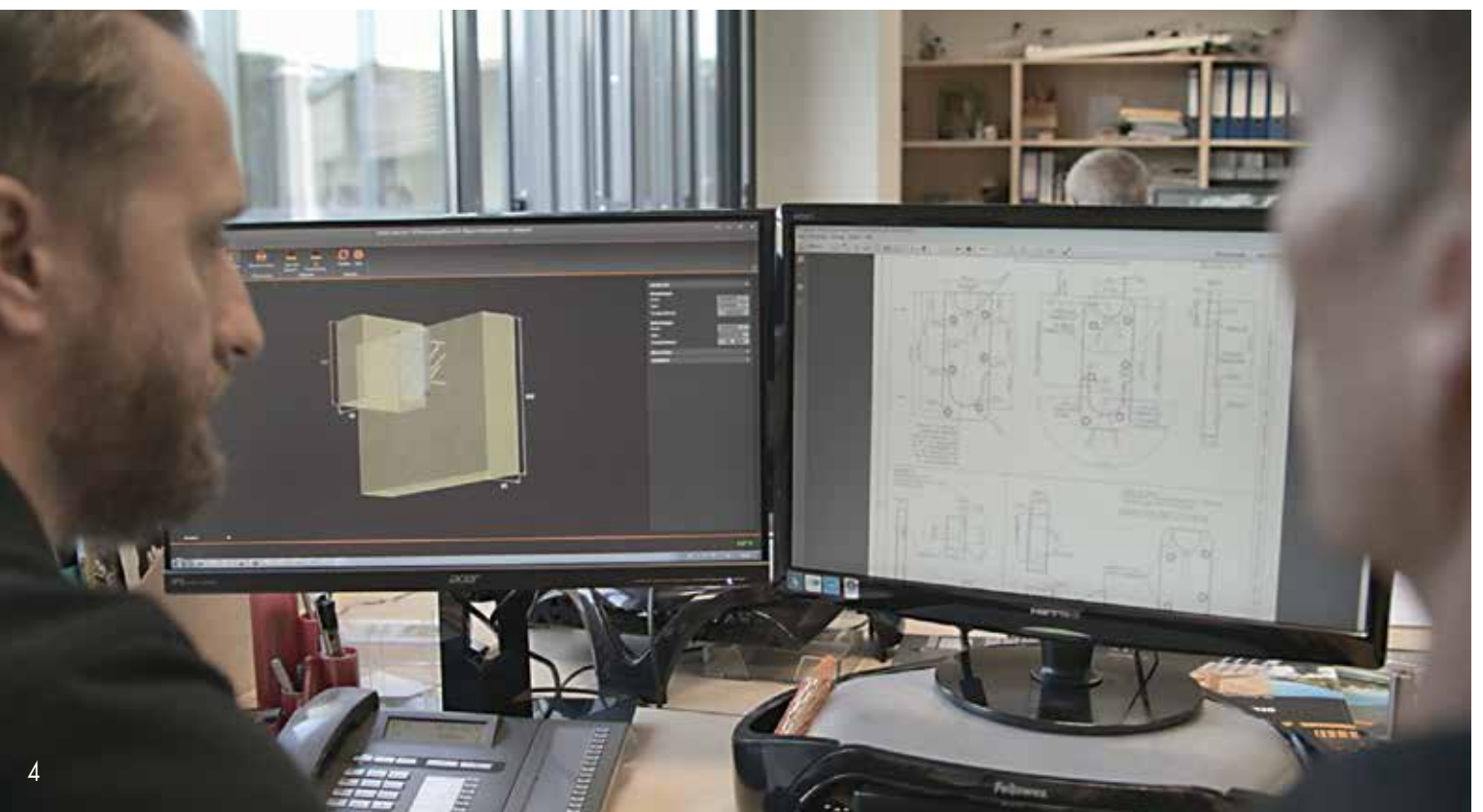



# SERVICE IS ONE OF OUR TOP PRIORITIES

To ensure that all requirements continue to be fulfilled, we keep the issue of sales in mind at all times and offer our customers an **extensive range of services**. During the construction process, our experienced sales reps support our customers on site, offering **customer-focused on-site assistance from A to Z**. This means that ideas can be developed and discussed right at the project site.

The **planning of large-scale projects** is also supported and coordinated by our sellers from the outset. For demonstration purposes, **varied suitable samples** for various application areas are produced for our salespeople. In addition, individual training sessions are offered to interested parties. These sessions are led by our employees with technical know-how and **many years of practical experience**.



WE CAN ALSO **TRAIN**  
**YOUR EMPLOYEES.**

GET IN TOUCH!

**+49 2331 62 45-444 OR**  
**TECHNIK@EUROTEC.TEAM**







# OUR COMPETENCES AS A MANUFACTURER

230

Oberfläche Surface:	Allgemein- toleranzen: ISO 2768-m	Maßstab/Scale: 1:2	Gewicht
	Name	Material:	
Datum		Benennung / Designation	
Erstellt 15.10.2019		Scherwinkel flach H-B	
Bezeichnet		Kundenzeichnung	Blatt
Gezeichnet		Zeichnung / Drawing	1/1
		Entwurf - 014.32	
		Rev. Nr.	1 von 1

**Eurotec GmbH**  
Ludwig-Bohm-Str. 5  
32076 Hagen

Alle Rechte vorbehalten. Nachdruck, Vervielfältigung und Verbreitung, auch auszugsweise, ist ohne schriftliche Genehmigung der Eurotec GmbH.

## ABOUT EUROTEC

We are a medium-sized company engaged in the development, production and sale of products for the construction sector. To this end, we supply products for the areas of timber-frame construction, deck construction and concrete fastening. We supply specialist dealers across Europe, who are responsible for distribution to skilled craftsmen.

### MILESTONES

**1999**

The two managing directors, Gregor Mamys and Markus Rensburg, founded Eurotec GmbH on 1 May 1999. The company began its life in a small basement with an adjoining garage, whose 5 pallet bays served as a warehouse.

**2003**

After multiple relocations within Hagen, the decision was made in 2003 to move to a company building in Werkzeugstraße. At the time, the warehouse had space for approx. 300 pallet bays. This warehouse also quickly became too small. After several expansions, capacity ran out and it was time for a new company building! The managing directors looked for and found a suitable location in Hagen.

**2007**

In 2007, the Eurotec team and its 30 members of staff moved into the new building at Unter dem Hofe 5. These newly built premises consisted of an office wing and an adjoining warehouse with approx. 3,500 pallet bays.

**2010**

Just three years later, the new building would, in turn, become the old building. A new warehouse building was built, providing a further 7,500 pallet bays and offices upstairs.

**2012**

In 2012, we decided to take the next important step. The foundation stone was laid for the production hall, paving the way for in-house production.

**2013**

From 7 January 2013 onwards, we produced a selected part of our proprietary product range in our own production hall in Hagen.

**2014**

In 2014, intensive work began on further expanding in-house production.

**2015**

Production capacity is expanded in 2015 to enable us to offer a wide range of solutions from our very own production facilities.

**2016**

In 2016, the company starts actively to build a new hall to relocate its machinery. Additional office space is being created in Hagen, since the company is enjoying steady growth. The next step is to expand the storage capacities in what was formerly the machinery hall.

**2018**

Completion of the new production hall in early 2018 means that all of the machinery can be moved. In addition, space was obtained for even more parking spaces with the construction of an additional warehouse.

**2019**

Our plastics production operations will be expanded in February to include two additional injection moulding machines, bringing our total number of machines to four. Screw production activities are also being expanded to include another multi-stage press. So we now have five machines for screw production in total.

**2021**

Our machine inventory continues to grow. This year, we will be adding two further plastics machines to our collection. We are also extending our online services to include Eurotec Coach and the Eurotec BIM platform.

**So, the end is still not in sight ...**



## IN-HOUSE PRODUCTION IN HAGEN

When production began in 2013, we took an important step forward in the company's history. Our success and ever-growing production facilities show that we are establishing ourselves in the market with our products.

**The benefits of in-house production are obvious:**

As we can better implement and constantly monitor our customers' high quality requirements. Short delivery times and swift responses to the demand of the market are additional advantages.



# FASTENING IS OUR PASSION

## Production capabilities

Whatever your requirements are, we provide you with **everything from a single source**. We produce in **various processes** such as stamping and stamping-bending technology, cold forming, injection moulding and extrusion technology.

## Production possibilities

- Screws from 160 mm – 1000 mm
- Simple, double or reduced thread
- Milling tips
- Different materials
- Different coating
- Individual customer requirements

## Surface process

From zinc to blue galvanized for long-term resistance in weathered areas (C4 - C5).

## Environmental consciousness

**No oil** on the floor, **no exhaust gas** in the air. **Energy generation** on our own roof. Compliance with legal and official requirements within an economic framework and the **promotion of environmentally conscious action** is an obligation for us.

### Self-milling ribs

For easy sinking of the screw in all kinds of timber

### Friction part

For pre-milling the wood for the shaft

### Thread with cutting notch

Diagonally offset, allows easy screwing – even in hard wood

### Tip geometry

For easy screwing in without splitting the wood

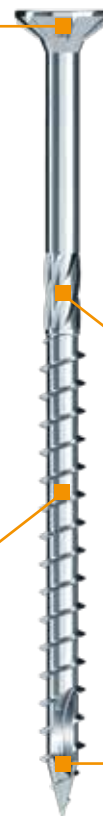



# QUALITY ASSURANCE AND CERTIFICATIONS

Our primary goal is to offer our customers flawless products and services and to guarantee **100 % adherence to delivery dates**. We expect an unrestricted commitment to quality from every one of our employees. The training and further development of a customer- and quality-oriented mindset and acting have always been a priority. Compliance with legal and official requirements within an economic framework and the promotion of **environmentally conscious action** is an obligation for us.

We are proud of the fact that almost all **our products in the timber, façade and concrete segments are ETA-certified**. It goes without saying that our quality assurance department checks the daily produced batches for standards such as compliance with the drawings, functionality, visual appearance and accordance with customer-specific specifications.

This is the only way we can be sure that we provide our customers with the **consistently high quality** they have come to expect from us.

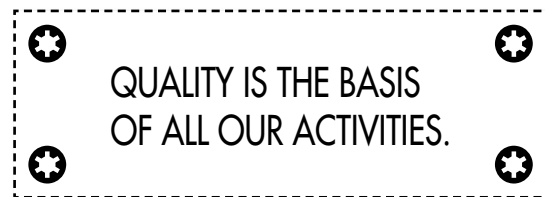

## SCREW PRODUCTION

When it comes to screw production, we benefit from a **modern multi-stage press**, which covers the individual processes from cutting the wire to depositing the produced screws. To ensure our customers always get the quality and delivery times they are accustomed to, we rely on our **in-house screw production**. This makes it possible to optimally implement and monitor customers' **highest quality requirements**.

The first priority is compliance with the legal and regulatory requirements in an economic framework while promoting environmentally conscious action. **ETA and CE-approved fasteners**, which perform bearing functions in various construction projects, offer the **highest level of security**. This is why we offer a variety of screws with ETA certification.



## COLD FORMING

Since production began in 2013, we have constantly expanded our production facilities in order to manufacture an ever-greater proportion of long-shafted cold-formed parts in-house at our location in Hagen. For example, these also include various special-purpose construction screws, such as the KonstruX fully threaded screws or the Topduo roofing screws.

At our production plant, cold-formed parts are produced with a diameter of up to 10 mm and a length of up to 1,000 mm. One particularly economical feature is that our machine allows us to automate up to eight machining processes. The relocation of the production facilities to a bigger hall meant that this area was also expanded to include additional machines.



**QUALITY FROM GERMANY!**  
AND WE'RE PROUD OF IT.





# STAMPING AND STAMPING-BENDING TECHNOLOGY

With this technique, we produce customer-specific solutions for a wide range of applications for clients around the world.

For this, we have eccentric presses at our disposal with a compacting force of 40 to 400 tons and a maximum stroke frequency of 400 strokes per minute. Strip widths of up to 500 mm and strip thicknesses of 0.15 to 8 mm are possible. Production is primarily carried out in coil form using progressive tools that were designed in-house.

In addition, our experts will be happy to advise our customers on material and surface selection. There is a wide range of possible variants and designs, so that we can identify the optimum solution for each area of application.

The focus here is always on close cooperation with our customers in order to satisfy their wishes and requirements as well as possible. Whatever the requirements are, we provide our customers with everything from a single source.

**FLEXIBLE PRODUCTION WITH BEST QUALITY!**

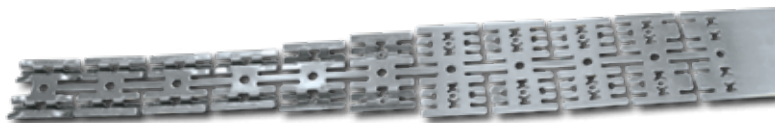

## INJECTION MOULDING

**Our product range includes multidimensional injection-moulded parts.**

With our modern machinery, we can process a wide range of thermoplastics, tailoring them to different requirements and applications. We are able to produce all kinds of plastic parts – not just industry-specific products. Our machines operate with holding forces of 30 to 220 tons.

**Eurotec's production is always environmentally conscious:**

100 % of rejected and defective parts are recycled, and the crushed material will be processed again.



### YOUR ADVANTAGE:



OUR MANY YEARS OF EXPERIENCE IN THE  
FIELD OF PLASTIC INJECTION MOULDED PARTS.



## EXTRUSION TECHNOLOGY

In the extrusion process, a raw material is heated and pressed under pressure through a forming tool.

The result is a long straight track which can be cut to length as desired. This process is used, for example, for aluminium profiles and WPC decking boards.

The main advantages are that **very complex shapes can be produced in large lengths** and with extreme precision.



TAKE ADVANTAGE OF THE MANY POSSIBILITIES  
OF THE EXTRUSION TECHNOLOGY.









# OUR PRODUCTS

TX30



## DECK CONSTRUCTION AND LANDSCAPING

### WHY A EUROTEC SUBSTRUCTURE?

Thanks to the modular system, Eurotec offers the **perfect solution for your terrace**. With our high quality adjustable feet and the aluminium profiles compatible with them, we offer you a **high quality and durable alternative to conventional substructures**. Whether large-format stone slabs, wood or WPC, planks, visible or non-visible mounting – we have the right solution for any application.

### WHY ADJUSTABLE PEDESTALS FROM EUROTEC?

Eurotec adjustable pedestals are extremely compatible – **they are available in various sizes, have variable height adjustment, and can even be expanded with extension rings**.

Thanks to our modular system, our adjustable feet are variably suitable for stone, wood or WPC coverings as well as for visible or non-visible fastenings. **Whether the Profi Line or BASE Line – our adjustable feet perform!**



## ALUMINIUM SUBSTRUCTURES

The Eurotec aluminium system profiles not only support the structural wooden protection, but they are also **dimensionally stable, load-bearing, and resistant to weather, UV exposure, insects and decay**. The special profile shape reduces the risk of fastening screws being shorn off as the result of swelling and shrinkage movements in the terrace decking boards.



## VISIBLE AND HIDDEN FASTENINGS

Depending on the type of wood, terrace decking boards can be fastened differently. **We offer you innovative solutions** that meet your individual requirements and wishes for fastening your terrace decking boards.



## DECK SCREWS

High-quality, high-performance screws are crucial when fastening terrace decking boards. It is **quick and easy to install terrace decking boards** with our high quality range of terrace screws.



## OUR **NEW** TERRACE SOFTWARE

The terrace software to facilitate material requirements planning for terrace construction now, in addition to a **general design update**, features not only a **super user-friendly interface**, but also a host of new features. These include, in addition to the industry-standard basics, **gradient and discharge planning, sketches** as well as **detailed product dependencies**, so that you always have the best results for your material requirements planning.\*

\*Without registering, you can access all planner features and plan up to 15 m<sup>2</sup> for free. For further planning options, simply register or contact us at [terrassequipen@eurotec.team](mailto:terrassequipen@eurotec.team).

\*\*You can use the Google Chrome browser to translate the website into your language and start working with the software straight away.







# TIMBER ENGINEERING

## A NEW ERA OF WOOD CONNECTORS

### THE SYSTEM INSIDE CORNER CLT IN COMBINATION

We offer a solution for every load case occurring in solid wood and timber frame construction in the form of brackets, straps, hook connectors or beam girders. We are currently working flat out on unique solutions for system connectors. These solutions are a system of all kinds of connections in modular and system design. Our optimised screw patterns enable absorption of high tensile and shearing forces. Consequently, fewer fasteners are required.

A construction can be extremely strengthened by connecting several interior corners of a system through the wood. This can be achieved with our IdeeFix or also hexagonal bolts, for example. There are numerous possibilities.

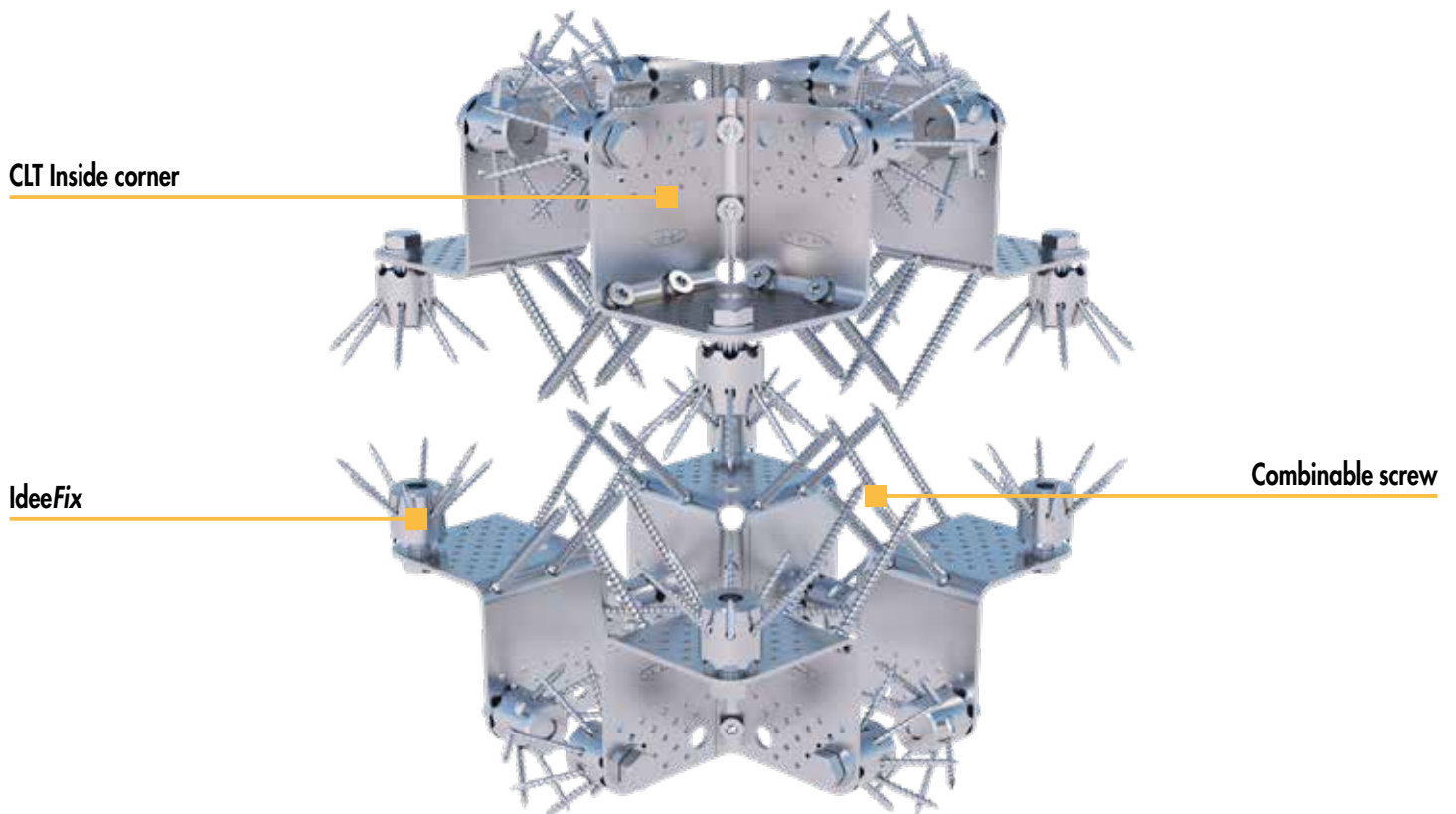

# STRONG CONNECTORS FOR A STRONG HOME

Cross-laminated timber (CLT) is a building material of the future!

The cross-laminated timber layers have proven to be **particularly stable, durable and also fire-resistant** and are therefore increasingly being used in construction projects around the world. The build time compared to conventional building materials is reduced due to the high degree of prefabrication of the individual CLT elements. This includes walls, decks and roofs, for example. This is why we offer suitable and high-quality CLT connectors that can absorb the highest loads possible in a small area. They are used in highly-stressed junctions of CLT structures and can absorb both transverse as well as tensile and shear forces.

**You will find some examples below.**

## OUR CLT CONNECTORS

We offer our CLT connectors in **different variations as well as dimensions** to have the right solution for every application.

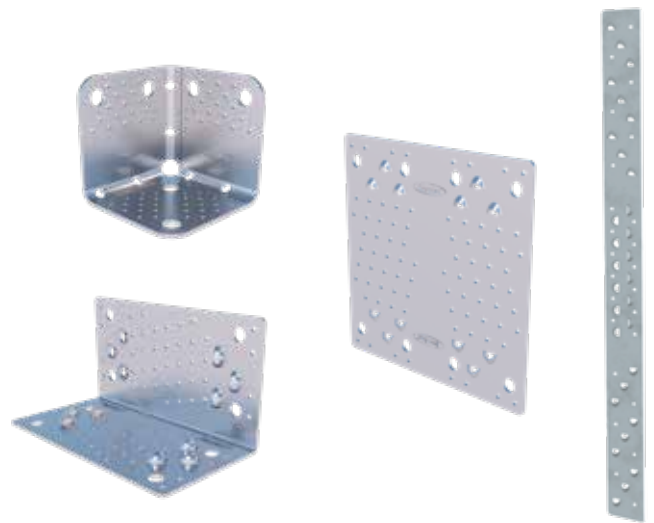

## HOOK CONNECTORS

The Eurotec hook connectors Magnus and Atlas are primarily used in main-secondary beam connections and also to create junctions in timber construction. They are characterised by a **high degree of prefabrication** and a subsequent **simple assembly**. The two components of the connectors are simply inserted into each other and then optimally connected to each other using fixing screws. Installation can occur visibly or non-visibly thanks to a 'shadow groove connection'.



## KONSTRUX FULLY THREADED SCREW

KonstruX fully threaded screws **maximise a joint's load-bearing capacity** with a high thread-extraction resistance in both components. If partially threaded screws are used, the joint's load-bearing capacity is limited by the considerably lower head pull-through resistance in the attached part.

KonstruX fully threaded screws are a **cost-saving alternative to traditional connections or timber joints** such as joist hangers and beams.



## SONOTEC

THE PERFECT SOLUTION FOR SOUND INSULATION

The Eurotec SonoTec consists of **sustainable material with a high load absorption**. It is not visibly laid, it is easy to handle, and is conditionally water and grass impermeable due to the component's specific nature.

You can find more information about the SonoTec products and the sound insulation cork in our complete catalogue:  
[www.eurotec.team/en/catalogues](http://www.eurotec.team/en/catalogues)



## ECS CALCULATION PROGRAM

The professional Eurotec calculation software (ECS) is used for the **static pre-dimensioning of Eurotec connectors** and helps you with your individual projects. We offer planners, craftsmen and architects our useful and free dimensioning service.

The ECS dimensioning software covers the areas of **structural timber engineering, wood-concrete composite and timber engineering**. The software is a useful basis for the fastening of wood-steel structural attachments as well. The dimensioning of objects, junctions or details occurs in the corresponding modules.

You can request access data to use the software for free on our website: [www.eurotec.team/en](http://www.eurotec.team/en)

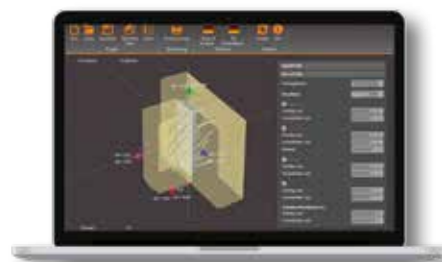

## OUR EUROTEC BIM PORTAL

All data at a glance

Many people, including architects, planners, craftspeople, and service providers, are involved in the construction of a building.

**In our new Eurotec BIM portal, we provide you with up-to-date BIM-relevant information on our product range.** You will have full access to 3D/CAD data, ETA certifications and much more. All portal functions are available to you free of charge! The files can be downloaded after a brief registration process.

Follow this link to the BIM portal:

[bim.eurotec.team](http://bim.eurotec.team)





# Eurotec<sup>®</sup>

# COACH



Not everything always goes according to plan on a construction site and, now and again, the right technical understanding, base knowledge or correct organisation is missing in the planning. With the new **Eurotec Coach** format, we use **explanatory videos**, brochures and technical articles to convey to you everything you need to know on the construction site, **making you the professional!**

✳️ AVAILABLE ON OUR ✳️  
✳️ **WEBSITE** SOON! ✳️



# EUROTEC WOOD CONSTRUCTION SCREWS

## Milling rib

For easy sinking of the screw in all kinds of timber



## Friction part

For pre-milling the wood for the shaft

## Thread type

**Double threaded** – Keeps the distance between wooden components



**Fully threaded** – For absorbing high tensile and compressive forces



**Partly threaded** – For a force-locked connection of several wooden components



## Drive

- No knocking of the screws when screwing in
- High torque transmission

## Head shape

### Countersunk-head



- Vanishes in the wood
- Closes flush with the surface

### Washer-head



- Enlarges the contact surface thus are higher head pull-through capacities possible

### Ornamental-head



- Small unremarkable head
- Ideal for visible connections

### Cylinder-head



- Vanishes in the wood
- Unobtrusive head for double threaded and fully threaded screws

## Screw tip

### Cut-tip



- Faster and simpler screwing-in

### AG



- Reduction of the screwing torque
- Reduced splitting effect

### DAG



- Reduction of the screwing torque
- Reduced splitting effect
- Screws have a better „bite“

### Drilling tip



- Reduction of the screwing torque
- High extraction resistance
- No pre-drilling necessary



# THE RIGHT SOLUTION FOR EVERY APPLICATION

Eurotec's timber construction screws have proven their **worth for years** and are **used worldwide**. Screwing in is made easier thanks to a variety of different properties, such as the friction shank or the milling ribs.

They are offered in **different quality classes and dimensions** to provide the **best-possible fastening alternative for the respective construction project**. The additional different thread types and screw tips therefore offer the right solution for every application.

## OUR BEST SELLERS

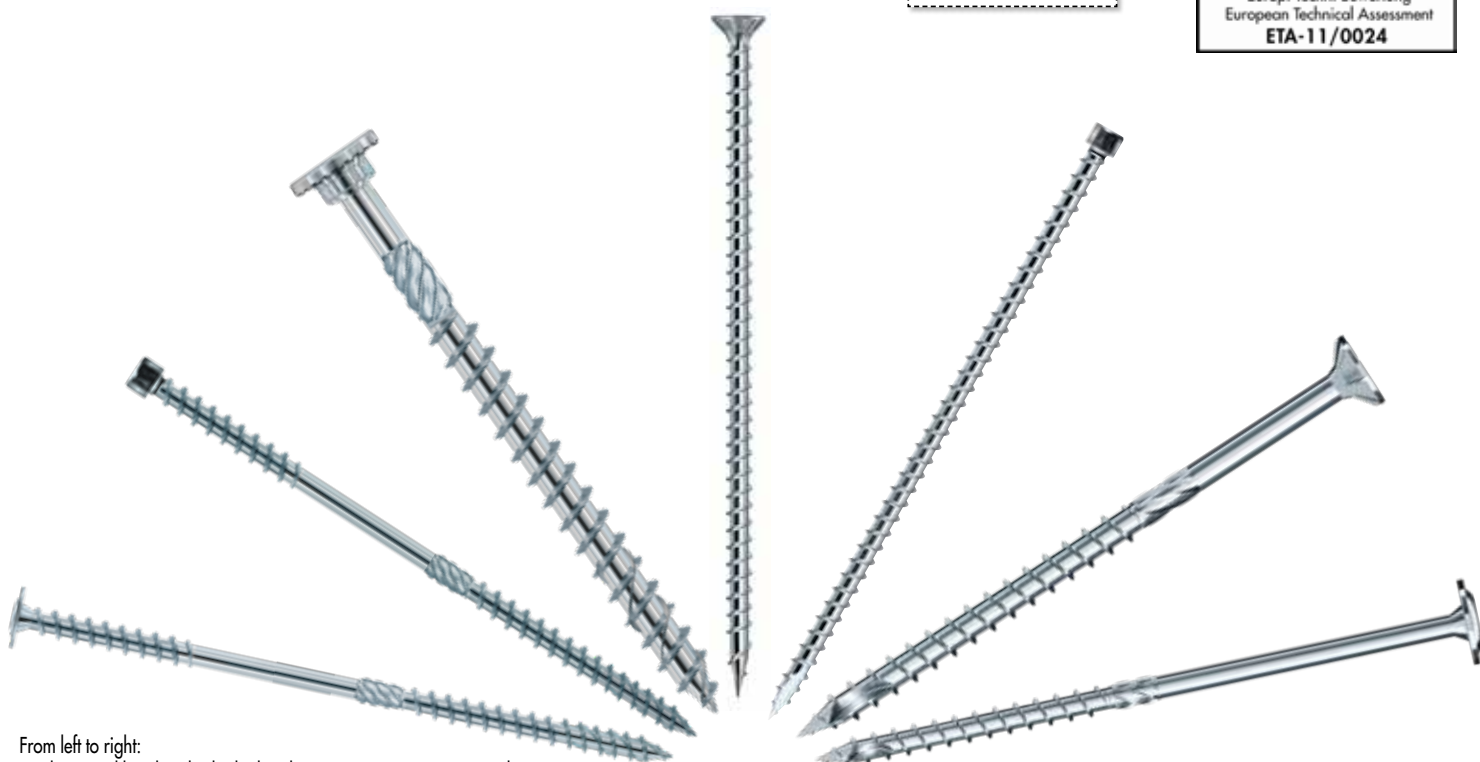

From left to right:  
Topduo round head and cylinder head, Sawtec, KonstruX countersunk and cylinder head, Paneltwistec countersunk and round head







## ROOF AND FACADE

### EISYS

FOR A WOODEN OR ALUMINIUM SUBSTRUCTURE

The EiSYS façade / adjusting screw is a **façade screw for assembling curtain-wall facing**. The big advantage is that the substructure can be directed parallel to the house wall thanks to the free-rotating threaded sleeve on the screw head.

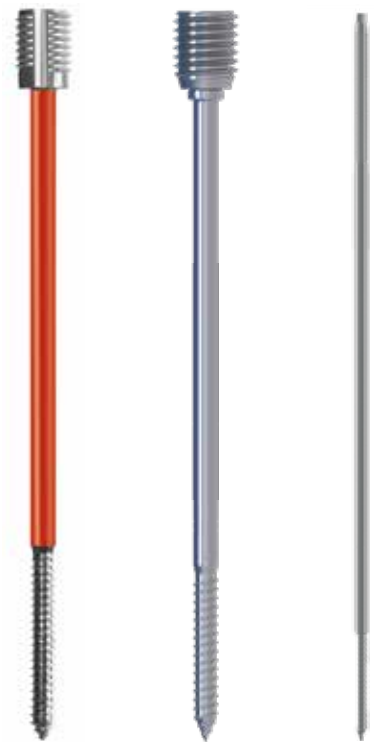
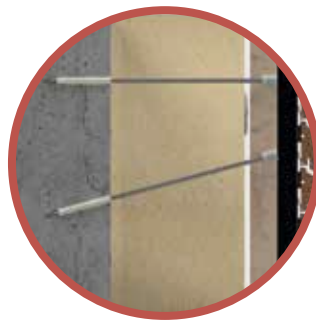
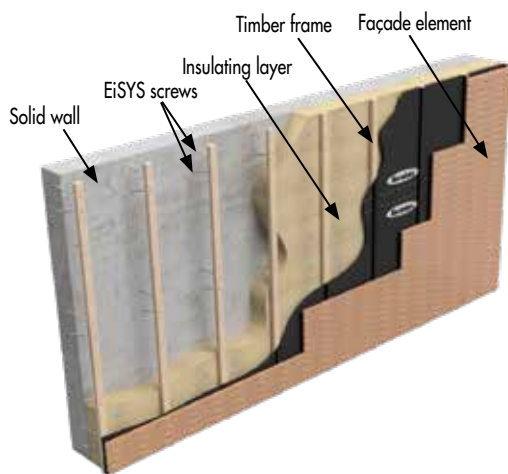

For additional information, please take a look at our façade brochure:  
[www.eurotec.team/en/catalogues](http://www.eurotec.team/en/catalogues)



### EISYS SOFTWARE

With the dimensioning software, we offer the opportunity to calculate for yourself how many EiSYS adjusting screws need to be used for your project.



## FAÇADECLIPS

Façade clips are used for **non-visible fastening** of façade woods. Moreover, they are used for structural wood protection, since the spaced installation creates a space to the substructure, allowing for **ventilation behind the façade**.

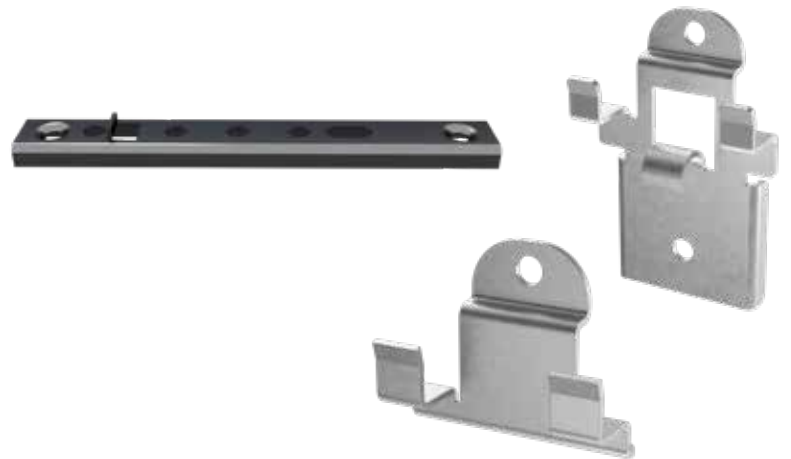

## ROOF SCREWS

Our roof screws are used to **secure different types of roofs**, such as flat roof insulation with step protection or also sandwich panels. Thanks to sealing washers and different types of heads and threads, among other things, our range of roof construction screws **covers a wide range of applications**.



## ROOF ACCESSORIES

Certain utensils are irreplaceable when expanding a roof. We offer a **high quality range of roof accessories**, which have proven their worth for years!





## CONCRETE AND MASONRY ANCHORS

### ROCK CONCRETE SCREWS

Rock concrete screws are used for **anchoring in normal concrete**. The advantage is that installation without an anchor is possible thanks to the special thread. The small expansion effect also allows for **small edge and axial spacing**.



### ACCESSORIES

With our accessories for concrete and masonry anchors, we offer the **right fastener** for almost **any installation in concrete**, such as high-quality anchors or bolt anchors, insulating anchors with a sealing plate or also injection mortar with suitable accessories.







## WOOD CONNECTORS

Our range of wooden fasteners includes, for example, timber construction fittings, such as joist hangers, tie rods, hanger straps and perforated plates or also post connectors as well as screw-on and drive-in ground sleeves. **High load-bearing capacities as well as corrosion resistance characterise our broad range of wooden fasteners.**

## POST HOLDERS

Post brackets are used **for fixing square wood posts**. The largely lateral post support allows for spacing between the ground and wooden profile, therefore promoting structural wood protection. They also have a **high level of corrosion protection thanks to the hot-dip galvanising.**

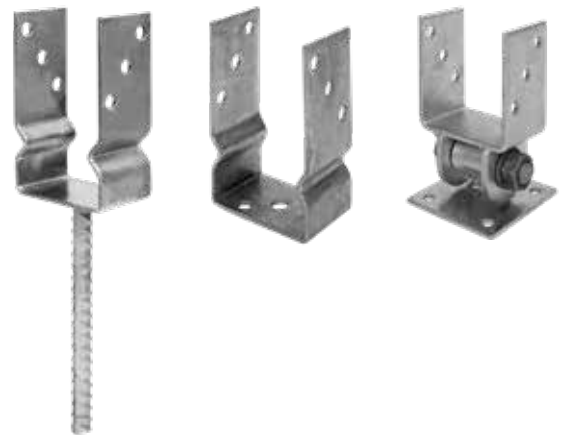

## POST ANCHOR 135 + 65

The post anchor 135 + 65 meets all the requirements of constructive wood protection. It can be installed on to the end-grain **without additional timber framing works and pre-drilling**. After installation, the post anchor can still be **adjusted up to 65 mm**. Manufacturing tolerances can be equalized through height adjustment.



## ECKTEC

**Replacing conventional braces is an absolute breeze with the EckTec connector.** Using the EckTec connector creates an attractive appearance without any bothersome braces. **This is particularly beneficial for low installation heights. It supports load absorption with horizontal forces.** Pre-assembly at the factory is possible.

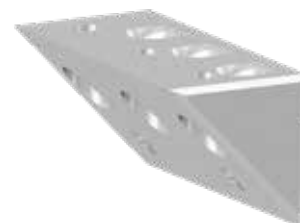



## FOR MORE SAFETY IN DAY-TO-DAY WORK

### WHAT IS SAFE & WORK?

Our SAFE & WORK products will get you **through your day-to-day work safely**. Whether working at heights or on the ground with our hard hats or in metalworking and woodworking with our safety shoes, we offer you a wide range of **high-quality** and therefore **durable products** that support you in any situation during your work.







## THE BEST TOOL FOR YOUR PROJECT

### THE BEST TOOL FOR YOUR PROJECT

ToolWorks offers you a **variety of tools** and products for timber construction, finishings and general handcraft. High-quality bits, combination lasers or spirit levels – the ToolWorks brand offers you choice **products for any application area** – all from a single source! Our products are suitable for all application areas and users – no matter whether for DIY, a carpenter or architect.

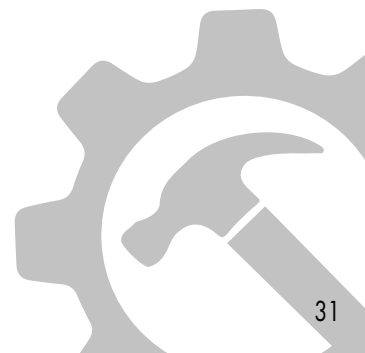





# EUROTEC AS A STRONG PARTNER





# STORAGE CAPACITIES

Whereas in 2014 there were still 11,000 pallet spaces, the new building has provided us with up to 20,000 spaces since the beginning of 2019.

Through the expansion of our warehouse we guarantee our customers a **consistently high turnover rate of incoming and outgoing goods**.

In addition, we have a large part of our product range in stock. For our customers, this means that we can almost always guarantee them a delivery time of a few days!

Also **short-term orders with individual quantities** we can deliver within a few working days.



✳ THE CONSTANT EXPANSION OF OUR WAREHOUSES UNDERLINES OUR PERMANENT GROWTH. ✳





# WORK TOGETHER WITH EUROTEC NOW!

Eurotec has taken up the task of manufacturing products to develop a solution that provides the professional user with an offer the **highest degree of advantages and innovative edge**. Thereby, individual products are always developed in close cooperation with the customer.

The core assortment consists of screws and fastening systems for the building materials timber and concrete as well as high-quality substructures and fastening systems for terrace construction.

It is the company's declared philosophy that not the price, but rather **the quality of the products is in focus**. That the price-performance ratio is ideal is attested to by a steadily growing customer base of more than 4,000 customers worldwide.

**TAKE ADVANTAGE OF THE WIDE RANGE OF PRODUCTS ON OFFER!**



 WE LOOK FORWARD TO  
 WORKING WITH YOU  
  
 **AS PARTNERS!** 





The specialist for fastening technology

**SO,  
HOW CAN WE  
HELP YOU?**

▶ IMAGEFILM



**20**  
**YEARS**  
of quality

**E.u.ro.Tec GmbH**

Unter dem Hofe 5 - D-58099 Hagen

Tel. +49 2331 62 45-0

Fax +49 2331 62 45-200

E-Mail [info@eurotec.team](mailto:info@eurotec.team)

[www.eurotec.team/en](http://www.eurotec.team/en)